

the lifestyle you deserve

THE P NE

3 BHK PREMIUM APARTMENTS

SINGLE FLAT ON EACH FLOOR

A PROJECT BY

Ficon
INFRASTRUCTURES
From dream to destiny...



THE PINE

3 BHK PREMIUM APARTMENTS

We understand the importance of home in life. It is not only a home but a world of dream and happiness.
“The Pine” is one of the most prestigious apartment scheme crafted by Ficon Infrastructures at prime location of Jafar Nagar.

The Pine offers 3 BHK luxurious apartments. It is a six stories building with modern amenities. Each floor contain one 3 BHK flat with more usable floor area and a specious sitting area & two large balconies. That fulfill all the requirements of a family to live lavish lifestyle.



GROUND FLOOR PLAN





TYPICAL 1ST TO 6TH FLOOR PLAN

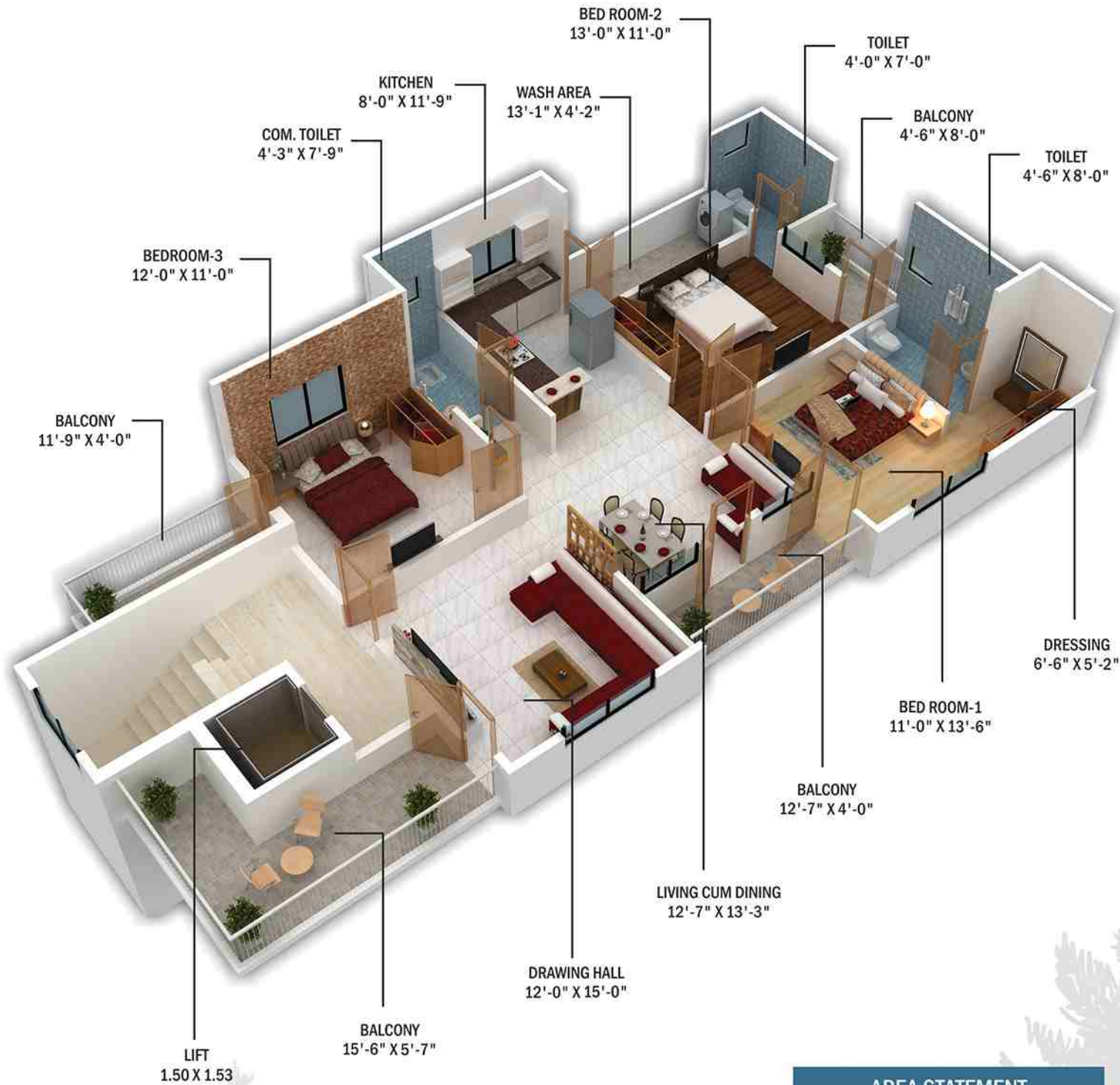

AREA STATEMENT	
FLAT NO.	S/B AREA
101 TO 601	1800.00 Sq. Ft.



SPECIFICATION

- **STRUCTURE**
R.C.C. Frame Structure (Seismic Zone II).
- **SUPER STRUCTURE**
External wall: 6" brick masonry. Internal wall: 4" brick masonry.
- **DOOR**
Main Door : Bajaj B-Secure main Door. Other Doors : Teak wood door frame with Moulded designer door.
Toilet Door: Waterproof doors /P.V.C. doors.
M/S Alluminium hardware for toilet doors.
- **WINDOWS**
Powder coated aluminium windows. M.S. Safety grills.
- **FLOORING**
Vitrified tile flooring in Hall, Bed Room & Passage. Concept Designer tiles in toilets.
- **KITCHEN**
Granite platform (otta) with stainless steel sink. Dado 2'0" above platform.
Provision for exhaust fan. Dry balcony with provision for washing machine.
- **TOILET**
Hot-Cold water mixer. Washbasin in each toilet. Plumbing materials of ISI grade.
Antiskid Ceramic flooring. Elegant quality CP fittings. Provision for geyser.
Premium sanitary ware.
- **WATER TANK & SUPPLY**
Municipal Water Supply
Underground tank with sufficient capacity.
Tube Well / Well Water Supply
Overhead tank for toilet & general washing use which shall be connected from the common well/tubewell in the plot. For lifting tube well 1.0 to 1.5 HP motor to be provided.
- **WATERPROOFING**
Water proofing in terrace, sump, water tank & all bathrooms.
- **PAINTING**
Exterior emulsion for External walls. Tractor emulsion for internal walls with putty finish in all rooms.
Teak wood polish door frame/panel.
- **ELECTRICAL**
ISI Mark concealed Copper wiring. Premium Modular switches point for AC in all bed rooms.
TV points in master bed room & living room ELCB/MCB for different circuits.
- **LIFT**
5 passenger automatic lift with power back-up.
Elegant lift lobby.
- **EXTRA CHARGES**
 - 1) Extra works other than specified and any changes in layout will be carried out on advance deposit payment partly, at the sole direction of the developer.
 - 2) No external/internal modifications shall be allowed to affect the external elevation.
 - 3) The purchaser has to pay the following charges separately.
 - a) MSEB meter deposit and S.L.C. Network charges including proportionate charges of transformer.
 - b) Water meter charges with other incidental charges of water pump etc.
 - c) Registration, stamp duty and documentation charges.
 - d) GST and any other tax applicable from time to time shall be extra and are to be borne by the purchaser.
 - 4) Possession after full & final payment.



AMENITIES



CCTV Surveillance For Common Area



Modular Kitchen



24/7 water supply



Automatic Water Level Controller



Automatic Lift With Power Backup



Full Covered Parking



Rain Water Harvesting



Sanitation Facility For
Servant & Drivers

OUR COMPLETED & ONGOING PROJECTS



GALAXY HEIGHT
Gorle Layout, Police Line Takli, Nagpur.



THE AVENUES
Ahhbab Colony, Police Line Takli, Nagpur.



KEYSTONE
Kamgar Nagar, Police Line Takli, Nagpur.



THE CORE
Main Road, Police Line Takli, Nagpur.



THE GALLERIA
Rathod Layout, Anant Nagar, Nagpur.



LINK APARTMENT
Near C.I.D Office, Nagpur.



THE RADIAN
Beside St. Vincent Pallotti School, Nagpur.



THE ORION
Ayyappa Nagar, Nagpur.

THE ARCH
Rajaram Society, Nagpur.



WEST AVENUES
Ayyappa Nagar, Nagpur.



WESTSIDE
Rathod Layout, Anant Nagar, Nagpur.



THE NEST
Khan Co-Operative Society, Nagpur.



EAST AVENUE
Rathod Layout,
Anant Nagar, Nagpur.

THE PINE
Gulistan Colony
Behind Pandey Lawn, Nagpur.

LOCATION MAP

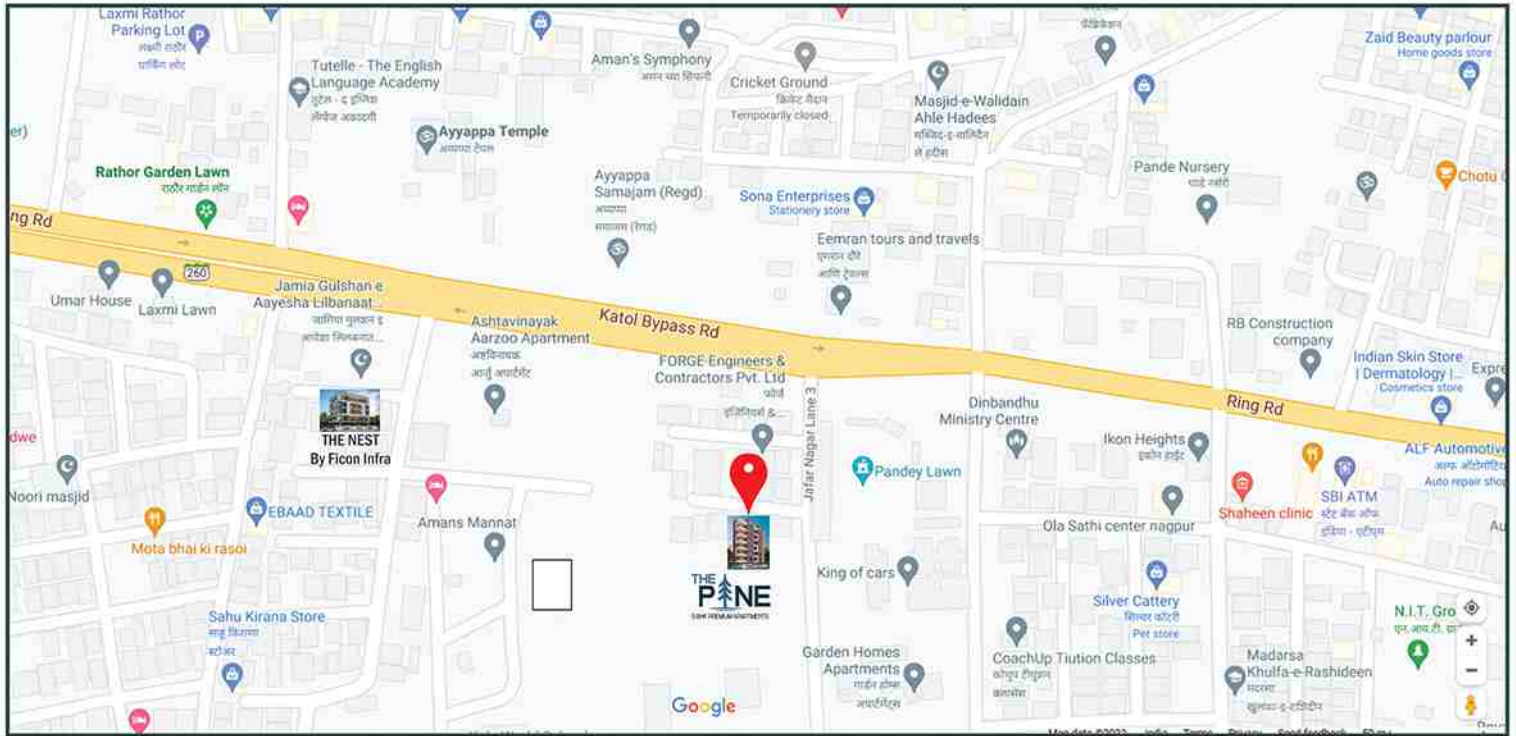

Site Address : Plot No. 33 & 34, Darshan Co-operative Housing Society,
Behind Pandey Amrai Lawn, Gulishtan Colony, Nagpur - 13.



A PROJECT BY

Ficon
INFRASTRUCTURES
From dream to destiny...

BUILDER & DEVELOPER

Naeem Khan : +91 9370 990 080

Asif Khan : +91 8552 990 080

ARCHITECTURAL CONSULTANT



85, Prashant Nagar, Near CID Office, Police Line Takli, Nagpur - 440013. Phone : (0712) 2587866.

Info@ficoninfra.com | www.ficoninfra.com

Note : This brochure is only a conceptual presentation of the project & not a legal offering. The promoters reserve the right to make changes in the elevation, plans & specification as deemed fit.